

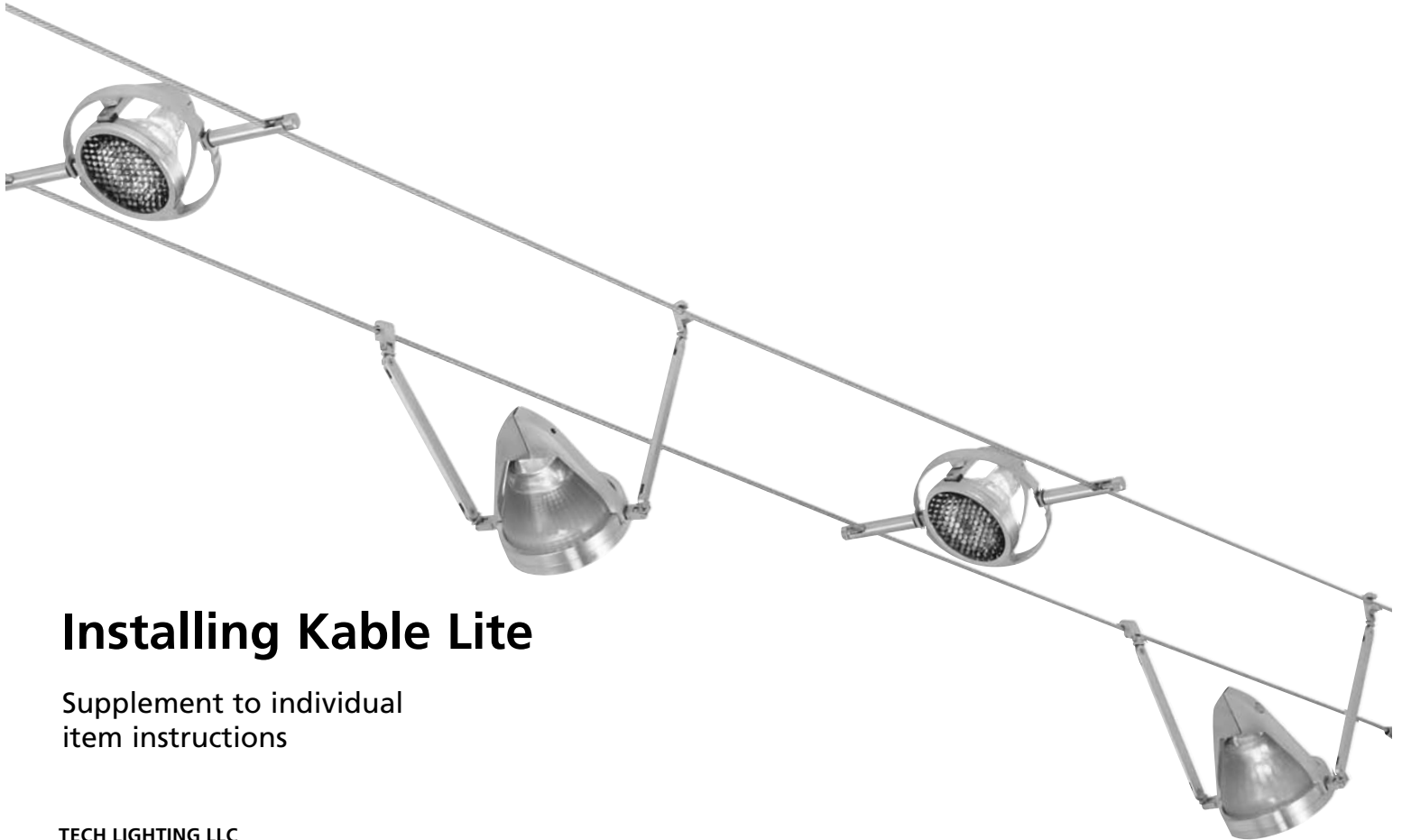

TECH LIGHTING®



Installing Kable Lite

Supplement to individual
item instructions

TECH LIGHTING LLC
7400 Linder Ave
Skokie, IL 60077

**SALES AND
CUSTOMER SERVICE:**
847.410.4400

**QUOTES AND
TECHNICAL ASSISTANCE:**
800.522.5315

FAX:
847.410.4500

www.techlighting.com



Certain products shown in this catalog have patent protection or patents pending. Tech Lighting reserves the right to discontinue or to change the technical or design specifications of its products at any time without notice. Copyright ©2005 Tech Lighting L.L.C. All rights reserved.

921KAB123.1

1 NC| U| UVGO QW
QP HNQT

2b INSTALL THE SURFACE
TRANSFORMER

3 INSTALL TURNBUCKLES
AND ANCHORS

6 CONNECT CANOPY
LEADS TO CABLE

5 INSTALL CABLE

4 INSTALL ADDITIONAL
SUPPORTS AND
HARDWARE

2a INSTALL THE REMOTE
TRANSFORMER

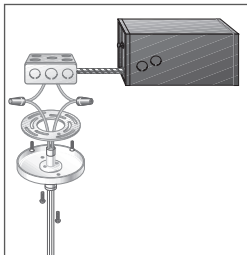

7 ADD ELEMENTS

8 RUN THE SYSTEM FOR
20 MINUTES

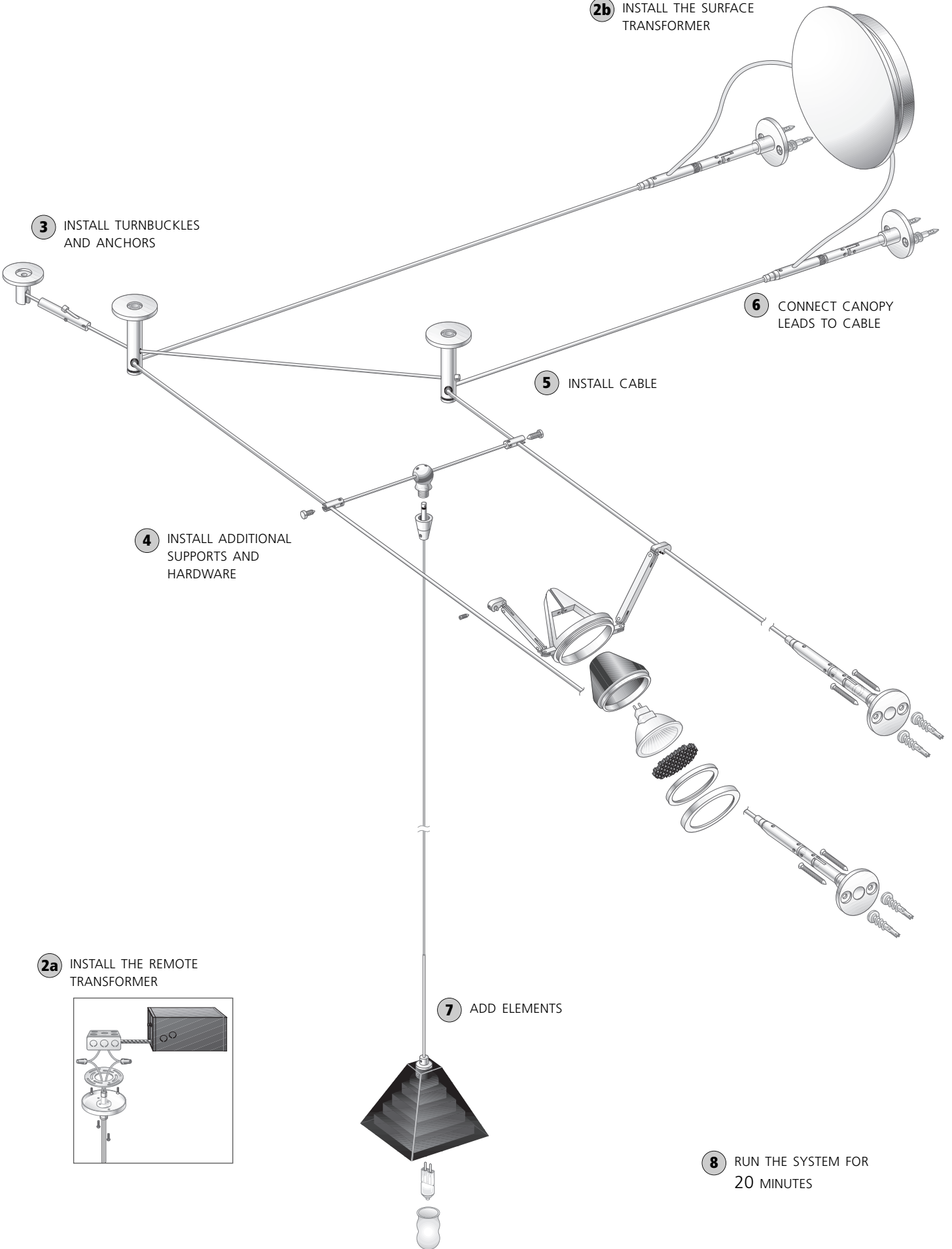

Installing Kable Lite

When installing and using this system, please adhere to the following basic safety precautions:

- Read all instructions completely before beginning installation
- Turn off the electrical power at the panel before modifying the system in any way
- Do not install this system
 - In a wet or damp location
 - With the fixtures located within six inches of combustible materials
 - With the rail concealed or extended through a building wall

We recommend you hire a qualified, licensed electrician to install the system.

Order of Installation

- 1 Unpack boxes, but keep packages intact to avoid losing small hardware pieces and instructions. Lay the system out on the floor as an overview of where individual items will be installed.

- | | | |
|--|----|--|
| <ol style="list-style-type: none"> 2a Install remote transformer <ul style="list-style-type: none"> • Determine location of transformer, j-box and canopy • Pull the correct gauge THHN wire from the transformer to the canopy (see voltage drop chart, below). Single feed canopies require two leads; dual feed canopies require four • Install canopy at j-box | OR | <ol style="list-style-type: none"> 2b Install surface transformer <ul style="list-style-type: none"> • Determine transformer location • Mount transformer to 120 volt j-box |
|--|----|--|

- 3 **Install the Kable Lite turnbuckles and anchors**
 - Carefully determine proper locations (Review all fixtures to determine the correct separation needed between cables)
 - Reinforce with wood blocking behind the wall for runs over twenty feet in length

- 4 **Carefully place and install additional supports and hardware, if any**
(Maintain proper cable separation)

- 5 **Install cable**
 - Fully extend turnbuckles
 - Feed each cable from anchor or turnbuckle through any supports or hardware to other turnbuckle
 - Adjust cables to be straight and taut; trim excess cable

- 6 **Connect the canopy leads to the cables**
 - Bend and trim off any excess lead wire or cable
 - Make sure power connections are very tight
 - Turn on the power; use a voltmeter to ensure the proper voltage

- 7 **Add elements**
 - Shorten fixtures if necessary
 - Install accessories and lamps Note: 24 volt transformers require 24 volt lamps
 - Place elements on system ensuring tight connections

- 8 **Run system for 20 minutes**
Turn off the system and check for any connections that are hot to the touch. Those that are hot must be retightened.accessories and lamps

Low-Voltage Wire Size Table							
Use this chart to determine the correct THHN wire size for an acceptable 3 percent drop in voltage at the specified wattage. The length shown is the length of wire from the remote transformer to the electrical J-box.							
		5 ft.	6-15 ft.	16-20 ft.	21-40 ft.	41-60 ft.	61-90 ft.
12 VOLT	150 watt	12 ga.	8 ga.	6 ga.	4 ga.	2 ga.	1 ga.
	300 watt	10 ga.	6 ga.	4 ga.	1 ga.	1/0 ga.	3/0 ga.
24 VOLT	300 watt	14 ga.	12 ga.	10 ga.	6 ga.	6 ga.	4 ga.
	600 watt	12 ga.	8 ga.	6 ga.	4 ga.	2 ga.	1 ga.

Troubleshooting

Did the breaker on the transformer trip?

- Confirm the transformer has not been overloaded
- If powering the system with more than one feed, ensure that isolating connectors are separating each feed
- Check that none of the elements are generating a direct short. If any elements have been shortened, check the FreeJack connector
- Check the low-voltage side of the transformer before the breaker with a voltmeter to ensure voltage does not exceed 12 or 24 volts

Is an individual element not working?

- Check that the lamp is installed securely
- Check the lamp to see if it has burned out
- Check the FreeJack connector for proper contact

Did the breaker on the main panel trip?

- Confirm that the circuit has not been overloaded
- Change the breaker in the panel to an inductive load breaker

Is the system still not working? Why not try checking the basics?

- Check the light switch (or cord switch on a plug-in transformer)
- Make sure the power feeds from the transformer to the rail are tightly connected
- Check for loose wire nuts in the electrical box, canopy, or transformer cover
- Make sure the transformer's 120 volt side is wired correctly

Dimming Issues

All Tech Lighting transformers may be dimmed with the appropriate low voltage dimmer: a low voltage magnetic dimmer for magnetic transformers; a low voltage electronic dimmer for an electronic transformer. The dimmer is placed on the input line before the transformer. It is very important to use the compatible dimmer type: failure to do so will substantially shorten the useful life of the transformer.

Reducing dimming noise

Dimming a transformer may create a buzzing noise, which may be objectionable in certain applications. To reduce buzzing, we recommend the following:

- Use the compatible dimmer type recommended for the transformer
- Add a debuzzing dimming coil in series on one of the 120 volt lines. All our magnetic surface transformers are shipped with a debuzzing dimming coil
- Load the system to at least 80 percent of capacity; for example, a 300 watt transformer should have at least a 240 watt load

Listings

Tech Lighting systems are tested and listed by major testing laboratories. Our system products are listed only when used as a complete system; that is, when all components, including transformers, have been provided by Tech Lighting. Substituting another manufacturer's product will render the listing completely void, Tech Lighting will be removed from liability, and any insurance coverage to which you may be entitled may be jeopardized.

ETL: Reference report #566697 City of New York calendar #39025